

NOTES: UNLESS OTHERWISE SPECIFIED

1. MANUFACTURED AND INSPECTED IAW AS9100 QUALITY SYSTEM REQUIREMENTS.
2. SEE DRAWING NO. 7625 AND PROCEDURE P-1000 FOR ASSEMBLY AND TEST INSTRUCTION. PROCEDURES AND ASSEMBLY DRAWINGS ARE FOR INTERNAL USE ONLY.
3. REFER TO KIT DRAWING 5-0600 FOR CMM, MOUNTING HARDWARE, AND INSTALLATION INSTRUCTIONS.
4. DIMENSIONS ARE INCH [MILLIMETERS].
5. MAXIMUM WEIGHT: 1.0 LB [.45 KG]

REVISIONS			
REV	DESCRIPTION	DATE	APPROVED

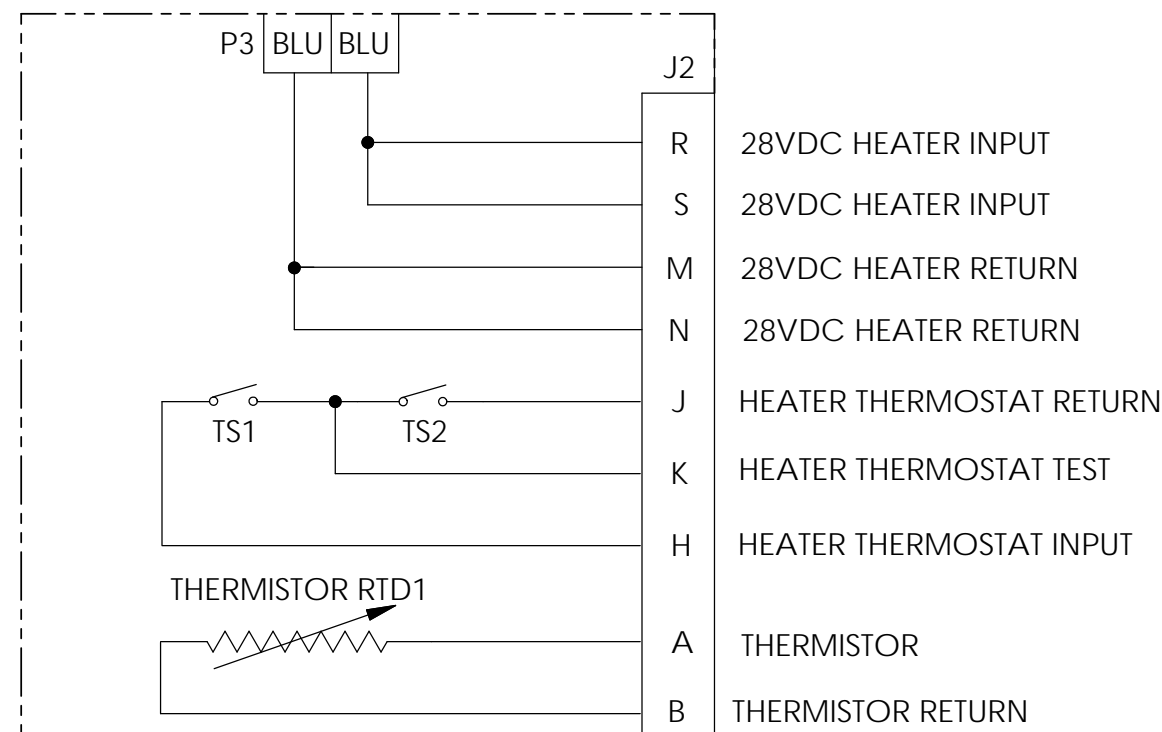

ELECTRICAL SCHEMATIC

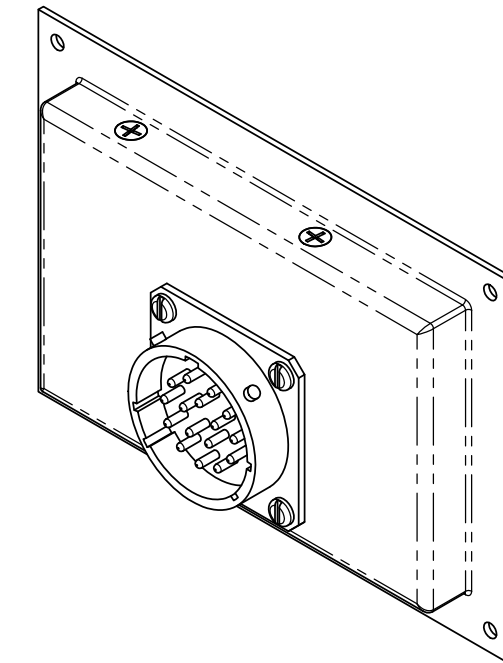

PART NUMBER: HCU-6

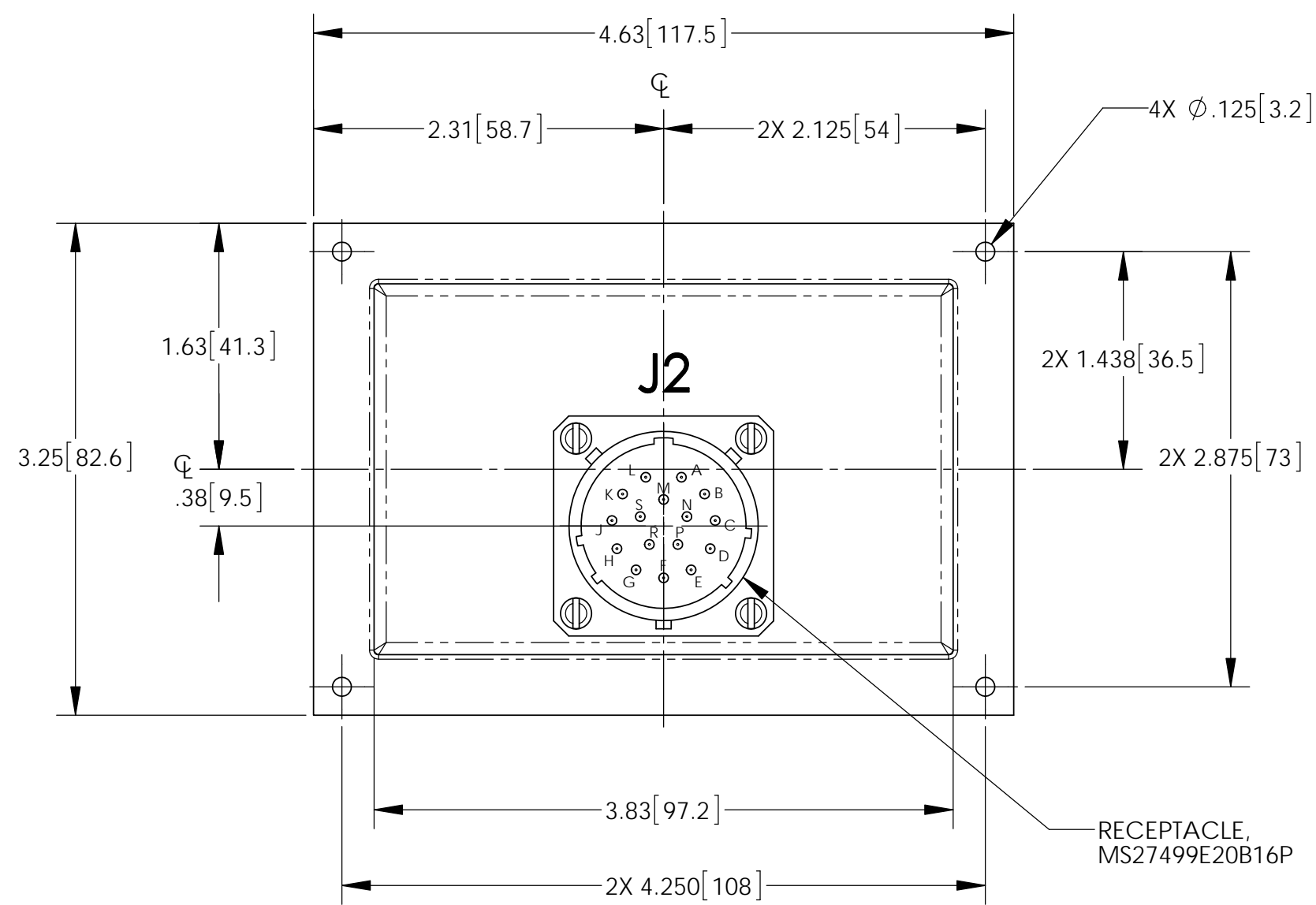

RECEPTACLE, MS27499E20B16P

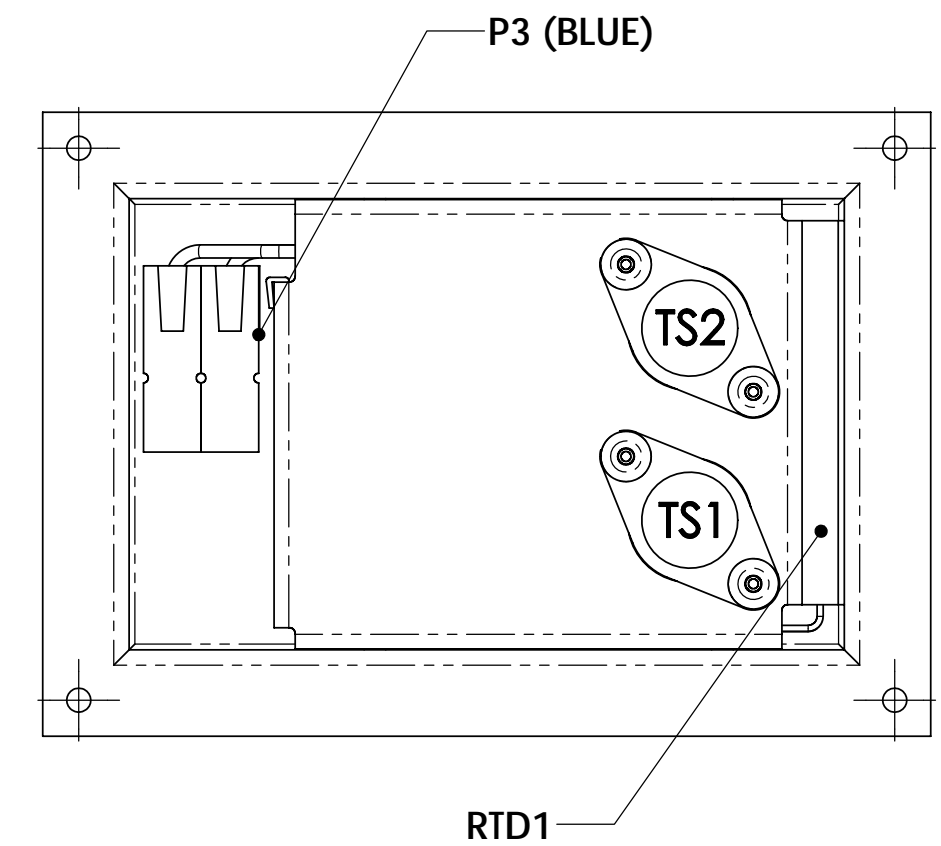
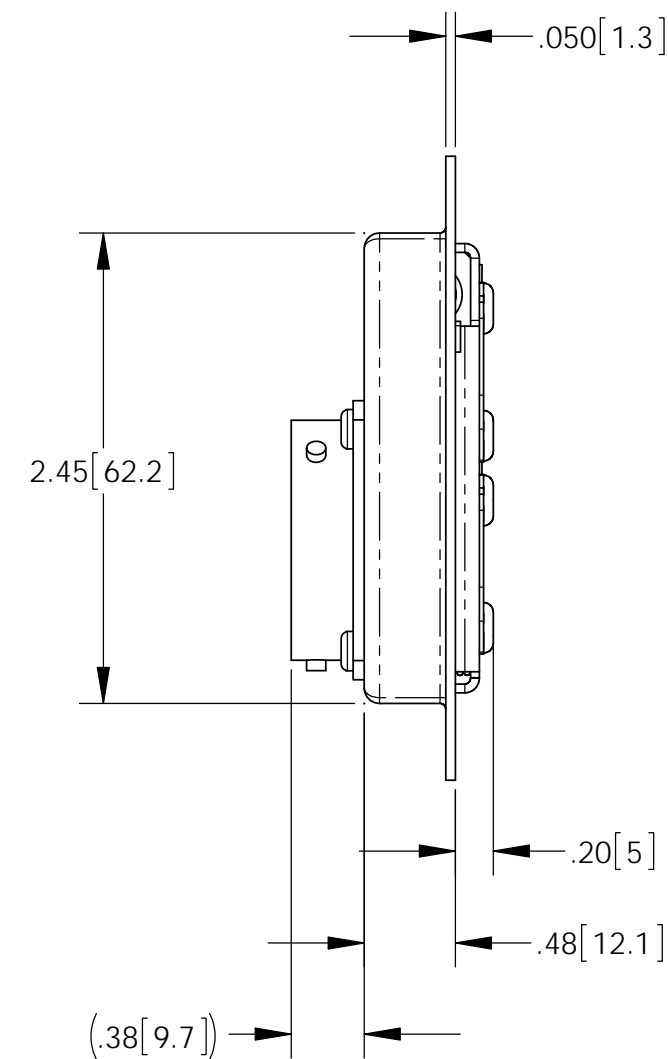

ENVELOPE DRAWING

UNLESS OTHERWISE SPECIFIED DIMENSIONS ARE IN INCHES TOLERANCES ARE:			CONTRACT NO.		CONCORDE BATTERY CORPORATION 2009 SAN BERNARDINO RD, W. COVINA, CA 91790		
FRACTIONS	DECIMALS	ANGLES	APPROVALS	DATE	TITLE		
±1/32	.XX ± .06 XXX ± .015	±1°	DRAWN	6/6/16	HEATER CONTROL UNIT, HCU-6		
TREATMENT	NONE	CHECKED	NS	6/13/16	SIZE	CAGE CODE	DWG NO.
FINISH	NONE	APPROVED	PH	6/13/16	C	63017	HCU-6
SIMILAR TO	CALC WT	ISSUED	JG	6/13/16	SCALE	1:1	SHEET 1 OF 1