

# Piper PA-46-500TP (M500) & PA-46-600TP (M600) STC Certified Heavy Duty Sealed Lead Acid Battery Installations



Image courtesy of Team Chemiliss

## FAA STC SA01050DE

## Brazilian Validation Pending

## TCCA – Eligible by SI 513-003

### Main Battery Upgrade –

Original equipment Piper P/N 601-910 (24V, 38Ah) is replaced with the higher capacity RG-41/53 24 volt TSO-C173a authorized battery.

### RG® Battery Advantages:

- Additional capacity for faster starting and reduced engine wear
- Longer battery life
- Concorde reliability, dependability and safety
- Ships Hazmat Exempt
- Fully recyclable - the green solution
- Widely available through a worldwide distribution network

Made in the U.S.A.

### Specifics:

STC provides for the installation of Concorde RG-41/53 high capacity valve regulated sealed lead acid (VRSLA) battery in place of the original equipment lead acid batteries in Piper M500 and M600 aircraft.

Concorde's RG-41/53 battery has the same design footprint and is therefore interchangeable without airframe modification.

1. Remove the existing main battery from the aircraft in accordance with (IAW) Piper Aircraft Maintenance Manual Section 24-30-00 sub section 15.C.
2. Install the RG-41/53 replacement battery IAW Section 24-30-00 sub section 15.E.
3. Insert the Concorde FAA approved ICA in the appropriate location in the AMM.
4. Complete the appropriate forms and return the aircraft to service.

### CONCORDE BATTERY CORPORATION

2009 San Bernardino Road | West Covina, CA 91790 USA  
626-813-1234 | Fax 626-813-1235 | [www.ConcordeBattery.com](http://www.ConcordeBattery.com)  
ISO 9001 + AS9100 | Crafted for Quality in the U.S.A.

...the heart of your aircraft®  
**CONCORDE**

FAA STC SA01050DE  
 Brazilian Validation Pending  
 TCCA – Eligible by SI 513-003

Main Battery Upgrade –  
 RG-41/53 (53 Ah)



RG-41/53 | 53 Ah

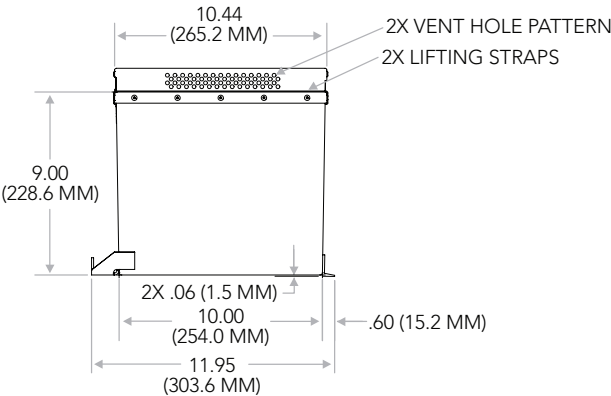
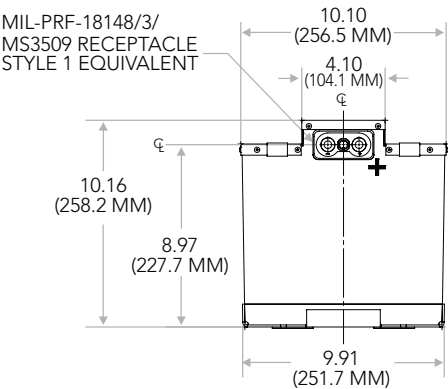

Part Number	Rated Capacity C1 in Ah	IPP 23°C / 74°F	IPR 1200	IPP -18°C / 0°F	IPR 1000	IPP -30°C / -22°F	IPR 800	Maximum Weight
RG-41/53	53 Ah	1650	1200	1325	1000	1125	800	96 LB / 43.6 KG

**CONCORDE BATTERY CORPORATION**  
 2009 San Bernardino Road | West Covina, CA 91790 USA  
 626-813-1234 | Fax 626-813-1235 | [www.ConcordeBattery.com](http://www.ConcordeBattery.com)  
 ISO 9001 + AS9100 | Crafted for Quality in the U.S.A.

