

NOTES: UNLESS OTHERWISE SPECIFIED

1. MANUFACTURED AND INSPECTED IAW AS9100 QUALITY SYSTEM REQUIREMENTS.
2. SEE DRAWING NO. 9709 AND PROCEDURE P-1000 FOR ASSEMBLY AND TEST INSTRUCTION. PROCEDURES AND ASSEMBLY DRAWINGS ARE FOR INTERNAL USE ONLY.
3. REFER TO KIT DRAWING 5-0387 FOR CMM, MOUNTING HARDWARE, AND INSTALLATION INSTRUCTIONS.
4. DIMENSIONS ARE INCH [MILLIMETERS].
5. MAXIMUM WEIGHT: 1.0 LB [.45 KG]

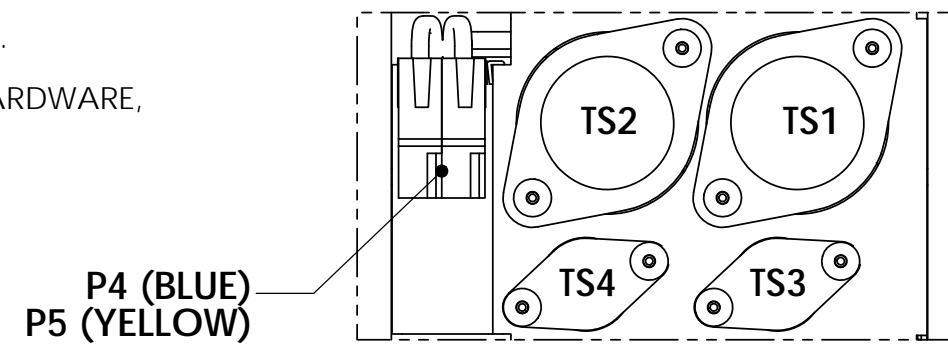

BACK VIEW  
(CROPPED)

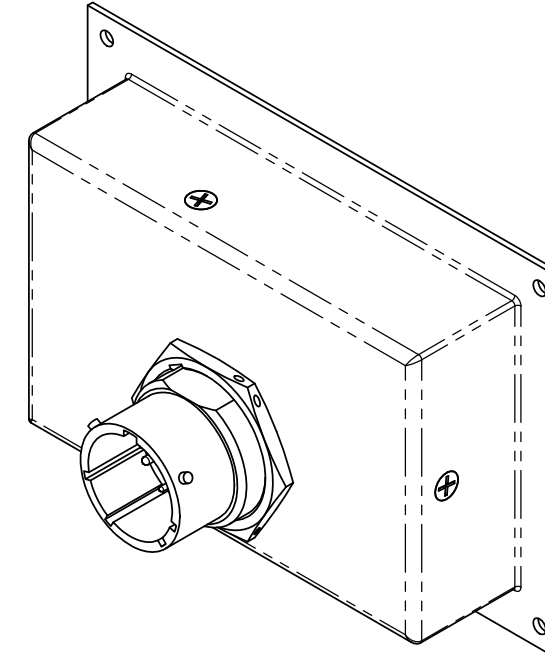

PART NUMBER: HCU-3

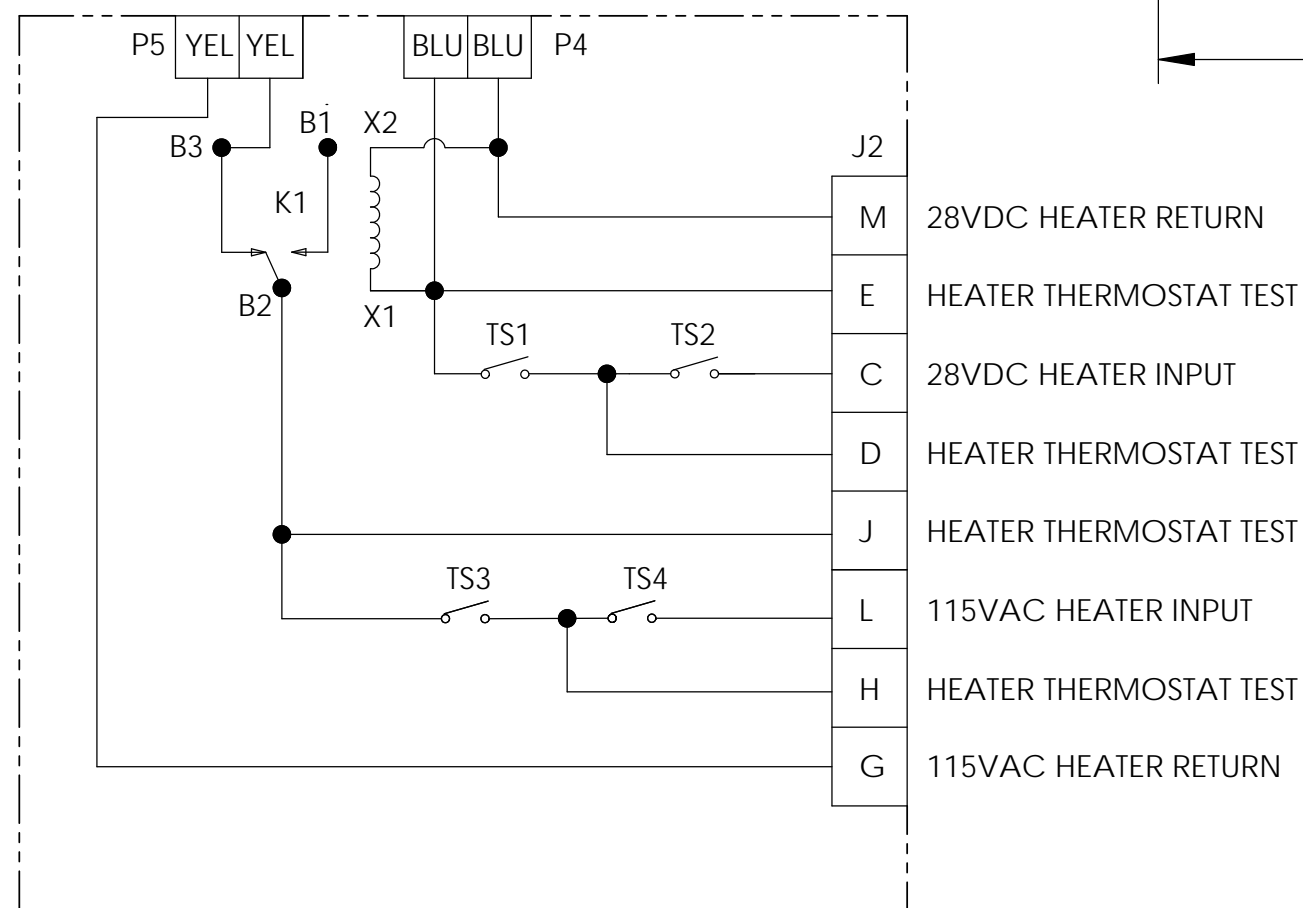
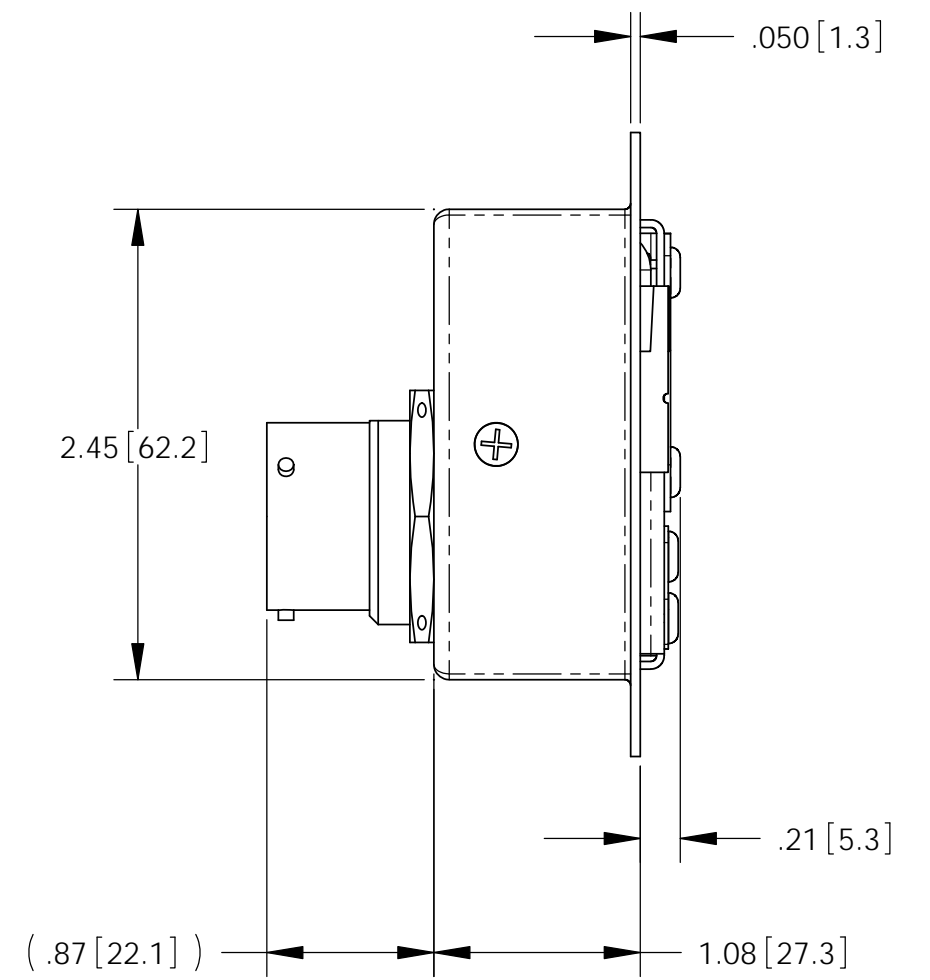
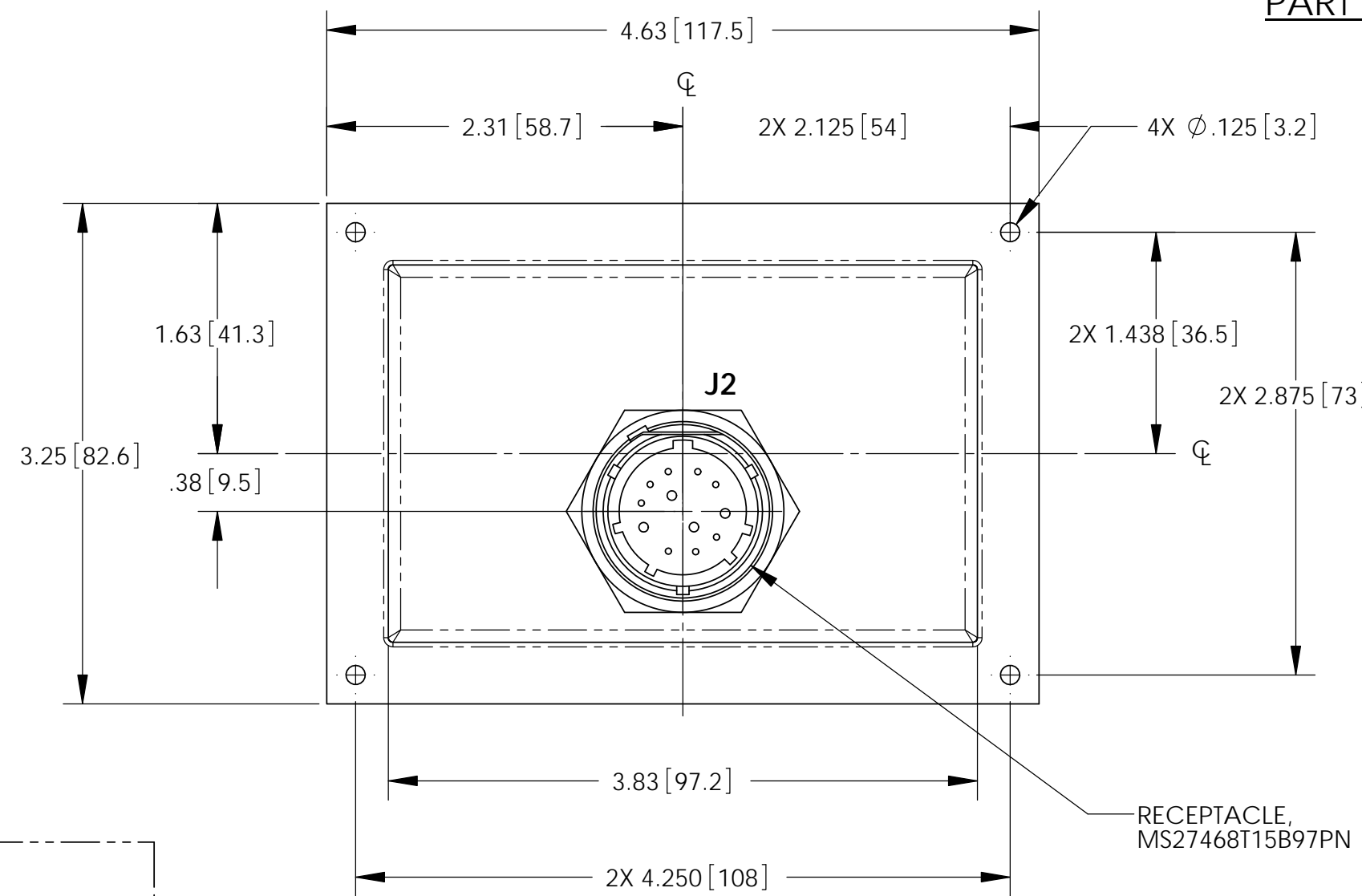

ELECTRICAL SCHEMATIC

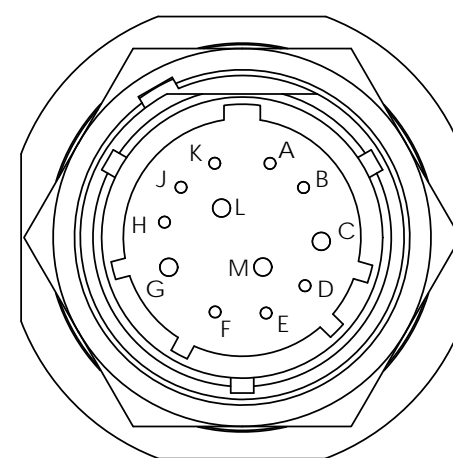

RECEPTACLE  
MS27468T15B97PN

ENVELOPE DRAWING

UNLESS OTHERWISE SPECIFIED DIMENSIONS ARE IN INCHES TOLERANCES ARE:		CONTRACT NO.		CONCORDE BATTERY CORPORATION 2009 SAN BERNARDINO RD, W. COVINA, CA 91790	
FRACTIONS	DECIMALS	ANGLES	APPROVALS	DATE	TITLE
±1/32	.XX ± .06 XXX ± .015	±1°	A. MISTRETTA	3/22/11	HEATER CONTROL UNIT, HCU-3
TREATMENT	NONE	CHECKED	AMIII	3/25/11	SIZE
FINISH	NONE	APPROVED	JBT	3/26/11	CAGE CODE
SIMILAR TO	CALC WT	ISSUED	BT	7/19/12	63017
					DWG NO.
					HCU-3
					SCALE
					1:1
					SHEET
					1 OF 1
					REV
					B