

NOTES: UNLESS OTHERWISE SPECIFIED

1. KIT TO BE PACKAGED AND CLEARLY IDENTIFIED USING KIT PACKAGING LABEL, ITEM 5.
2. SCREWS, ITEM 4, TO BE CLEARLY IDENTIFIED WITH PART NO. 6424 (BAG & TAG).
3. TS-C6A IS EQUIVALENT TO FOXTRONICS BATTERY TEMP SENSOR P600-14B.
4. MATES WITH FOXTRONICS TEMPERATURE INDICATORS:
 SINGLE DIGITAL DISPLAY, DBTI-2001
 DUAL DIGITAL DISPLAY, DBTI-2002
 ANALOG DISPLAY, BTI-600(SERIES)

REVISIONS			
REV	DESCRIPTION	DATE	APPROVED
A	REV ITEM 1 & NOTE 1, RENUM NOTES 2 & 3 TO 3 & 4, ADDED NEW NOTE 2 & ITEM 5, UPDATED PL DESCRIPTIONS	10/31/11	JBT

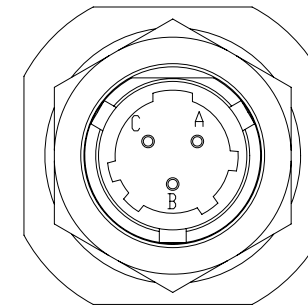

RECEPTACLE
PT07E8-3P OR PWO-07P8-3P-SPL

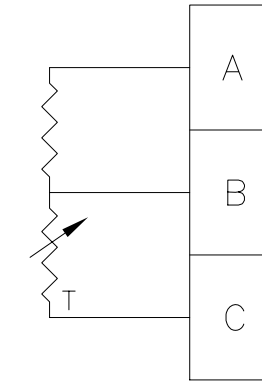

SCHEMATIC DIAGRAM

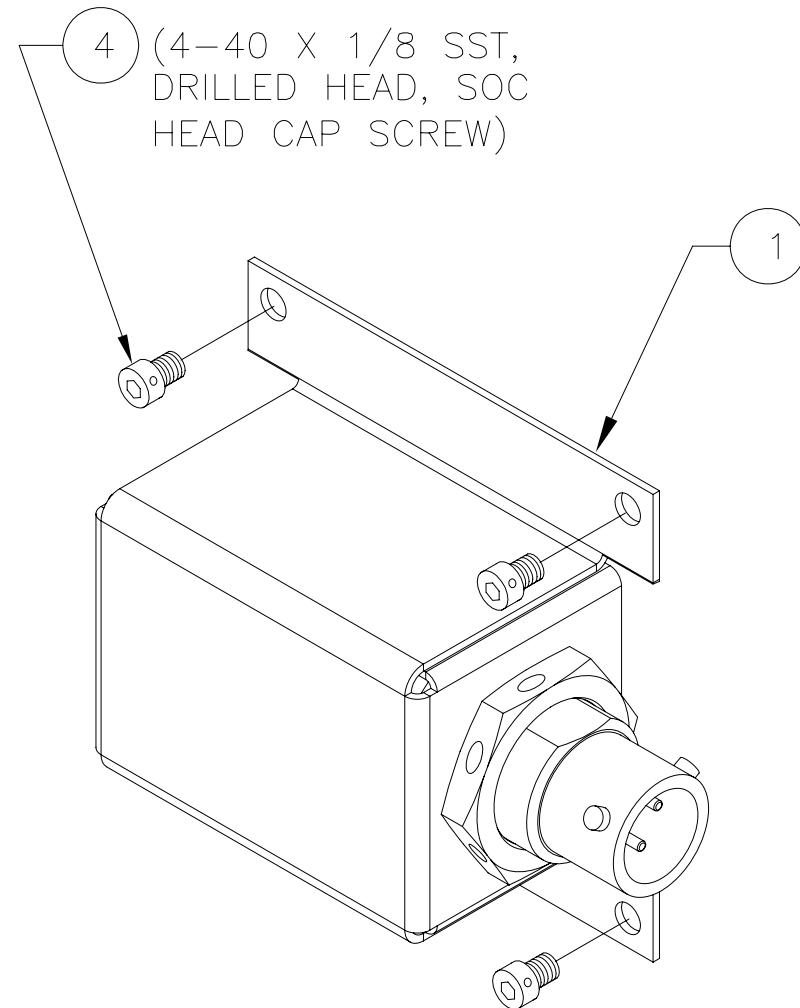

QTY REQD	CAGE CODE	PART OR IDENTIFYING NO.	NOMENCLATURE OR DESCRIPTION	MATERIAL SPECIFICATION	ITEM NO.
1		6234-6A	LABEL, KIT PACKAGING		5
4		6424	SCREW, CAP, SOCKET HEAD, DRILLED, SST		4
1		5-0135	ICA, TS-C6 SERIES		3
1		5-0117	INSTALLATION INSTRUCTION, L SERIES SENSORS		2
1		TS-C6A	TS-C6A TEMPERATURE SENSOR ASSEMBLY		1

PARTS LIST

UNLESS OTHERWISE SPECIFIED DIMENSIONS ARE IN INCHES TOLERANCES ARE: FRACTIONS DECIMALS ANGLES ± .XX ± ± .XXX ±			This document contains data which is PROPRIETARY to Concorde Battery Corp. Any use thereof is subject to the proprietary interest of Concorde. No data is to be disclosed to others without the written permission of Concorde Battery Corp.			CONCORDE BATTERY CORPORATION 209 SAN BERNARDINO RD, W. COVINA, CA 91790		
TREATMENT NONE			APPROVALS		DATE		TITLE KIT, TEMPERATURE SENSOR, TS-C6A	
FINISH NONE			DRAWN D AYALA		4/15/04		SIZE CAGE CODE DWG NO. REV	
SIMILAR TO NA			ACT WT NA		CALC WT NA		B 63017 5-0242 A	
ISSUED BT			11/1/11		SCALE NONE		SHEET 1 OF 1	